

Tillage disc

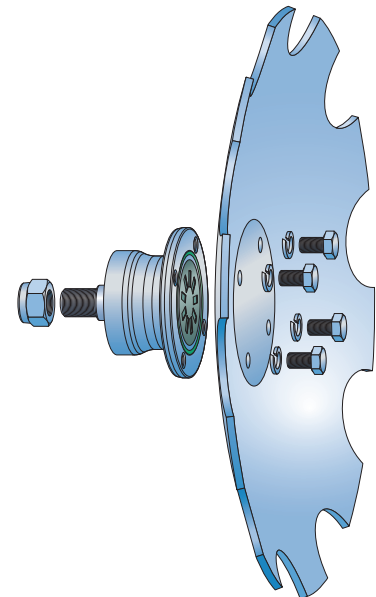
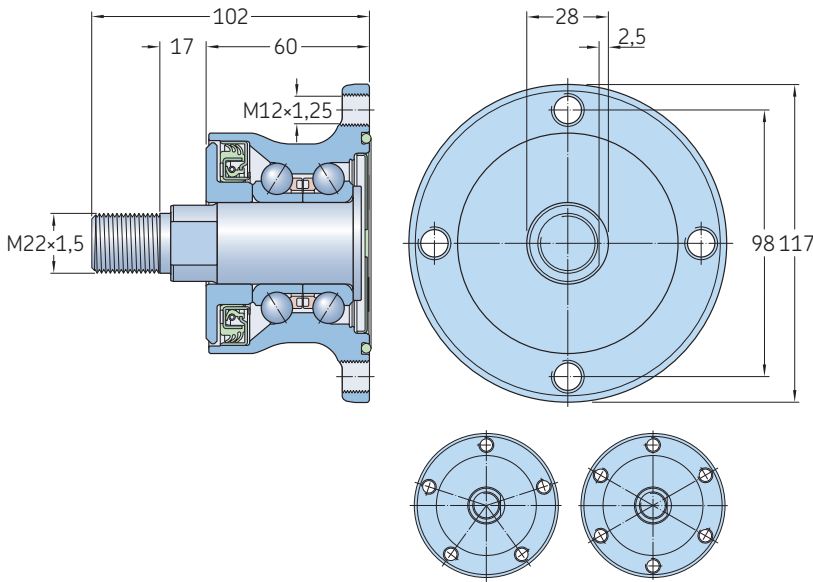

Designation	Attachment holes in outer ring	Basic load ratings		Shaft
		dynamic	static	
–	–	C	C ₀	–
		kN		–
BAA-0004	4xM12x1,25	47,5	37,5	Included
BAA-0012	5xM12x1,25	47,5	37,5	Included
BAA-0006	6xM12x1,25	47,5	37,5	Included
BAA-0003	4xM12x1,25	47,5	37,5	Not included

Plating is free from hexavalent chrome

Application description

The Agri Hub is a fully integrated hub bearing system, greased and sealed for the life of the unit. These hub units have a flanged outer ring that is pre-drilled and tapped to accommodate a disc. The stationary inner ring is fitted with a threaded stub shaft for easy mounting onto virtually any implement arm.

Main features

- Anti string system flange shape
- Anti straw, Arizona dust and stones labyrinth
- High performance sealing to prevent water, snow, mud, dust ingress
- High capacity bearing with rigid design to withstand shock loads
- Plating corrosion (CR VI-free) resistant to jet cleaning and fertilizers
- Anti contamination cap for disc replacement

Typical application conditions

- Tractor speed: 5–20 km/h
- Disc speed: 90–350 rpm
- Disc diameter: 300 to 800 mm
- Loading: maximum 3 kN (applied on top of the disc)
- Temperature: –20 to +50 °C (static –50 °C)
- Harsh working conditions: straw, strings, stones, fertilizers, mud, dust, water, snow and jet cleaning

Mounting instructions

- Screws mounting torque: 100 Nm
- Nut torque: 300 Nm
- Self locking nut

Tillage disc

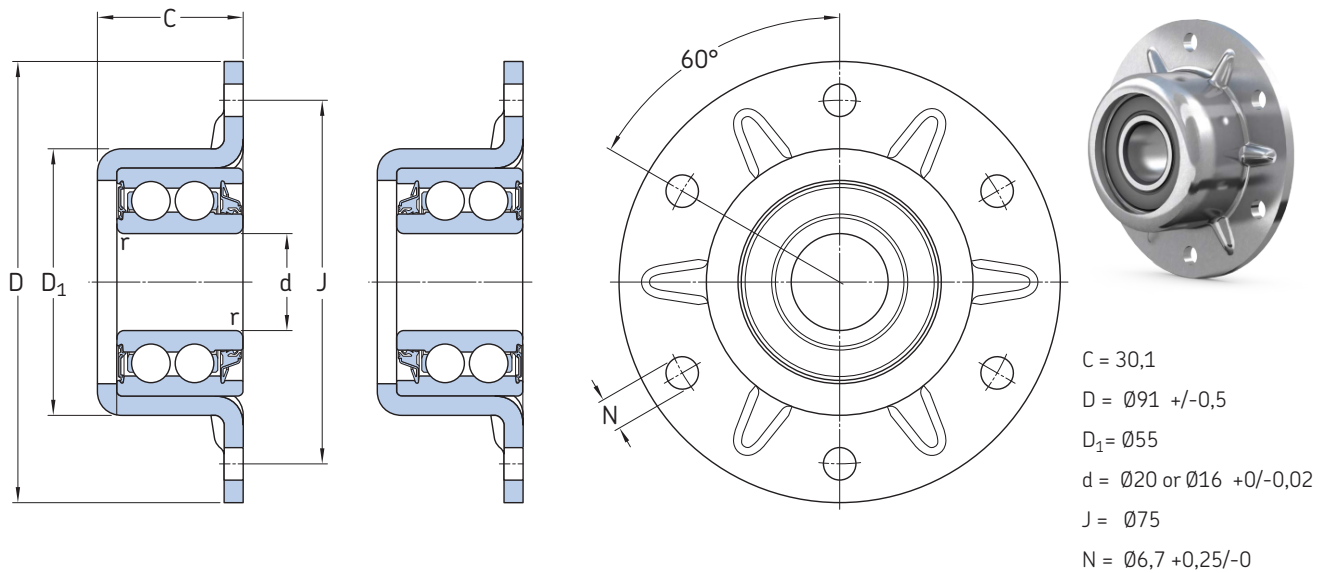

Designation	Attachment holes in outer ring	Basic load ratings		Bearing unit	Bore diameter d	5 Lip seal position
		dynamic C	static C ₀			
-	-	kN		-	mm	-
BB2-3500	-	20,8	13,2	Bearing	-	-
ADH-7545	6 x Ø 6,7 + 0,25	20,8	13,2	Flanged unit	20	on flange side
ADH-7545 B	6 x Ø 6,7 + 0,25	20,8	13,2	Flanged unit	16	on flange side
ADH-7546	6 x Ø 6,7 + 0,25	20,8	13,2	Flanged unit	20	on opposite flange side
ADH-7546 B	6 x Ø 6,7 + 0,25	20,8	13,2	Flanged unit	16	on opposite flange side

Mounting instructions:

- M6 x 1 screws mounting torque 10,4 Nm
- M16 x 1,5 nut torque 110 Nm
- Self locking nut

Additional options

An optional protection cap is also available on demand. BB2-3500 is provided as a single part without flanged unit

Product description

Ideal for minimum tillage or direct seeding applications, the standard Agri Hub for seeding discs is available as a fully assembled hub unit with a metal-sheet flange. Sealed-for-life and relubrication-free, the unit's primary features include:

- Double-row deep groove ball bearing, enabling a higher carrying capacity compared to conventional one-row designs
- Eco-zinc coating, contributing to long service life and precision performance
- Robust five-lip seal design that helps extend bearing service life, reducing maintenance and repairs
- Design flexibility: the standard 16 mm and 20 mm hub units are available with or without flange to accommodate design requirements.

Benefits

End-users

- Increases bearing unit service life by up to 40%*
- Reduces maintenance and ownership costs by up to 20%*
- Can be installed or replaced quickly and easily
- Improves profitability
- Fast delivery worldwide

Seeding machine applications

- Seeding/coulter discs
- Opener discs
- Closing discs
- Row markers